

*The*  
**IMPERIAL**  
HOTEL AND CONVENTION CENTRE  
PHITSANULOK

# FACTSHEET



Phitsanulok, Thailand

The  
**IMPERIAL**  
HOTEL AND CONVENTION CENTRE  
PHITSANULOK

The Imperial Hotel and Convention Centre Phitsanulok features 11 meeting rooms with over 1,500 sqm meeting space at the Phitsanulok Convention Centre and 6 small meeting rooms. All professionally designed meeting facilities are perfect for everything from small meetings up to 20 or so and full-blown conferences in the prestigious The Phitsanulok Convention Hall that accommodates up to 2,000 persons. It is the ideal Phitsanulok venue for conferences, launch events and banquets. The hotel has parking for up to 500 cars. All meeting facilities are fully equipped with modern audio visual equipment and MICE materials.

Meeting Room	Dimensions (metres)			Banquet/Event		Meeting/Convention			
Name	W x L	Sqm	Ceiling Height	Banquet	Cocktail	Conference	U-shape	Classroom	Theatre
Phitsanulok Convention Hall	44 x 35	1,540	10	1,200	1,500	500	500	1,000	2,000
Convention Hall	20 x 35	700	10	540	700	200	200	450	1,000
Wangpikul 1	10 x 20	200	6	100	120	50	50	100	150
Wangpikul 2	10 x 10	100	6	50	60	25	25	40	70
Wangthong 1	10 x 20	200	6	100	120	50	50	100	150
Wangthong 2	10 x 10	100	6	50	60	25	25	40	70
Wangtara	15 x 28	420	8	250	300	120	120	250	500
Aranyika	20 x 20	400	10	200	250	100	100	140	300
Tararin	6 x 12	72	3	30	40	25	25	30	40
Noen Maprang 1	5 x 10	50	2.6	20	30	15	15	20	30
Noen Maprang 2	5 x 10	50	2.6	20	30	15	15	20	30
Noen Maprang 3	5 x 10	50	2.6	20	30	15	15	20	30
Pool Side	-	-	-	350	500	-	-	-	-



**PHITSANULOK CONVENTION HALL**



**WANGPIKUL**



**ARANYIKA**



**WANGTARA**

# MEETING ROOM FLOOR PLAN

MEETING ROOM | PHITSANULOK CONVENTION HALL  
2,000 SEATS

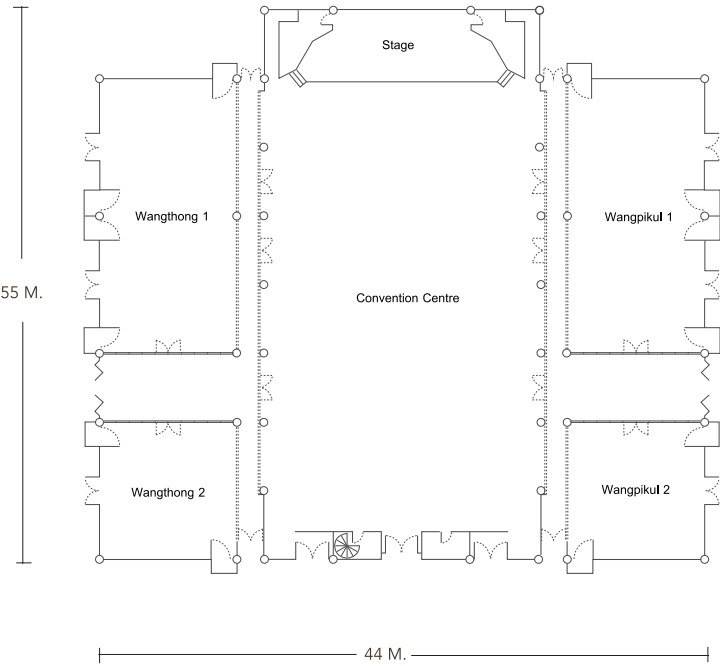

MEETING ROOM | TARARIN  
40 SEATS

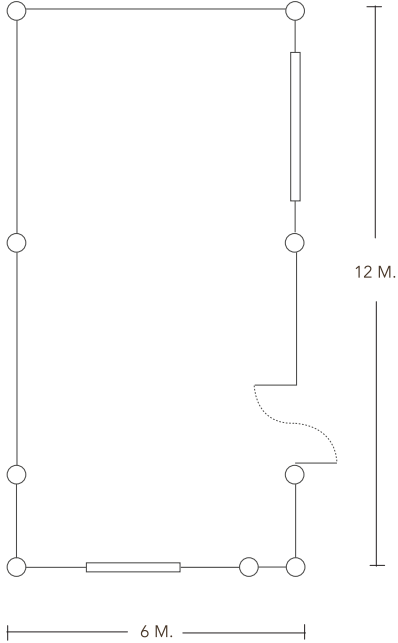

MEETING ROOM | ARANYIKA  
300 SEATS

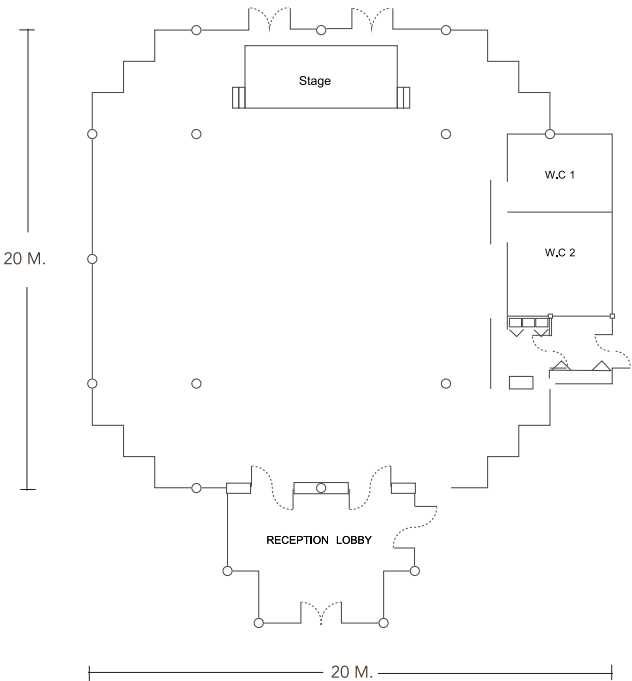

MEETING ROOM | WANGTARA  
500 SEATS

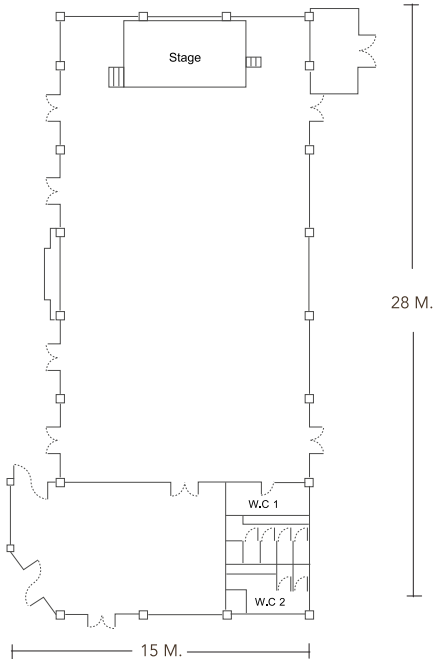





The Imperial Hotel and Convention Centre Phitsanulok located in the idyllic province of Phitsanulok, features 296 spacious, clean, and comfortable guest rooms, fully-appointed guestrooms, The Imperial Restaurant, Imperial Lounge, a lagoon-shaped swimming pool, full-scale fitness and Imperial Massage. Strategically located in the city center of Phitsanulok, just 15 minutes from Phitsanulok Airport, steps from Chaloe Phrakiat 80th Year Park, and one hour from Sukhothai Historical Park.

## ACCOMMODATION

Deluxe Premium	35 sqm	248
Junior Suite	70 sqm	1
Imperial Suite	80 sqm	2
Duplex Suite	72 sqm	6

## ROOM FEATURES

Air-Conditioning  
Bathroom Amenities  
Free WiFi  
Coffee and Tea Making Facilities  
Flatscreen TV  
Hairdryer  
2 Complimentary Bottles of Water Daily  
Working Desk

## HOTEL FACILITIES

Swimming Pool	10:00 hrs. - 19:00 hrs.
Fitness Centre	10:00 hrs. - 20:00 hrs.
Imperial Massage	13:00 hrs. - 23:00 hrs.
Parking Space (500 cars)	24 hrs.

## GUEST SERVICES

Airport Transfer	upon request
Chartered Van Service *For A Fee	6:00 hrs. - 23:00 hrs.
Laundry & Dry clean Service	8:00 hrs. - 17:00 hrs.
Room Service	6:00 hrs. - 23:00 hrs.
Free WiFi Access in Public Areas	24 hrs.

## RESTAURANTS & BAR

The Imperial Restaurant	6:00 hrs. - 23:00 hrs.
Imperial Lounge	10:00 hrs. - 23:00 hrs.
Pool Bar	10:00 hrs. - 19:00 hrs.

## ATTRACTIONS

Wat Phra Sri Rattana Mahathat	3.4 km.
Market	4.7 km.
Kek River Rafting	59 km.
Noen Maprang	70 km.
Phu Hin Rong Kla National Park	119 km.
Thung Salaeng Luang National Park	137 km.

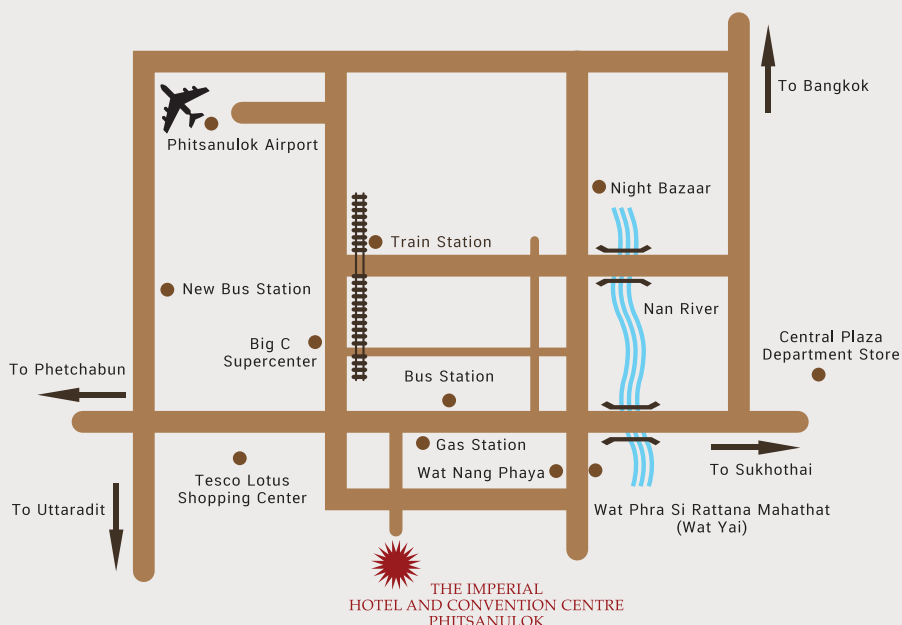

## ADDRESS

**The Imperial Hotel and Convention Centre Phitsanulok**  
52/299 Pra-Ongkhao Rd., Aranyik, Muang, Phitsanulok, 65000, Thailand

Sales Office:  
Tel: +66 (0) 5522 0999



www.imperialphitsanulok.com  
Imperialphitsanulok  
@imperialphitsanulok  
Email: info@imperialphitsanulok.com

GDS Code:  
Sabre Galileo Amadeus  
320505 E6260 PHS863

Reservation Center  
Tel: +66 (0) 2 237 7700 # 2561  
Mon - Fri 08:30 - 17:00 hrs.  
Email: rsvn@imperialhotels.com  
www.imperialhotels.com