



ສະບາຍດີ ຫລວງພະບາງ





The Grand Luang Prabang Hotel is located on the banks of the grand Mekong River with a spectacular panoramic view of the picturesque mountains surrounding Luang Prabang, approximately 4 kms southwest of Luang Prabang town centre.

The resort is situated on the 59 thousand square meters' estate of Xiengkeo Palace which belonged to the nationalist hero Prince Phetsarath.



LUANG PRABANG



The Grand Luang Prabang Hotel

Ban Xiengkeo, Khet Sangkalok,
P.O. Box 1191, Luang Prabang, 06000, Laos



 www.grandluangprabang.com

 /TheGrandLP

Sales Office:

Tel: +856 (71) 253 851 Fax: +66 (0) 2628 5292

Email: info@grandluangprabang.com



@grandluangprabang



@grandluangprabang

ACCOMMODATION

Deluxe Twin	35 Sq.m	47
Deluxe Double	35 Sq.m	13
Mekong Deluxe Twin	35 Sq.m	5
Mekong Deluxe Double	35 Sq.m	5
Executive Suite	70 Sq.m	3
Mekong Executive Suite	96 Sq.m	2

ROOM FEATURES

- Flat-screen TV
- Wide Range of Amenities
- Mini Bar and Refrigerator
- Fresh Fruit in Mini Basket
- Working Desk
- Safety Deposit Box
- Hair Dryer
- Slippers
- Bathrobes
- Bathtub in Suite Room
- Individually Controlled Air-Conditioning
- 2 Complimentary Bottles of Water Daily

HOTEL FACILITIES

• Business Centre	8:00 - 17:00 hrs.
• Swimming Pool	11:00 - 19:00 hrs.
• Gym	8:00 - 21:00 hrs.
• Wi-Fi & Internet Access	24 hrs.
• Spa	8:00 - 21:00 hrs.

GUEST SERVICES

Airport Transfer	Upon request
Shuttle Service	As per request
Laundry & Dry Cleaning Services	8:00 - 17:00 hrs.
Room Service	11:00 - 22:00 hrs.
Free WiFi Access in Public Areas	24 hrs.

RESTAURANTS & BARS

Xiangkeo Restaurant	6:30 - 22:00 hrs.
Le Bistrot	11:00 - 22:00 hrs.
Pool Bar	11:00 - 19:00 hrs.
Executive Private Dining	17:00 - 22:00 hrs.



THE PALACE

Prince Petcharath Ratanavongsa (1890-1959) holds a special place in Lao History as the only viceroy of the Kingdom of Laos and had a tenure as prime minister from 1942 to 1945. His tenure as Prime Minister of Laos was during World War 2 both under French protectorate & Japanese occupation.

Post the Japanese occupation, Prince Petcharath was in favor of an independent Laos which was to the contrary to the King's sentiments which was in favor of the French Protectorate. In 1946, he became the leader of the Lao resistance movement that sought to suppress the country's return under the tutelage of French colonials in favor of a free Laos. The difference in opinion led Prince Petcharath to leave the country for Thailand and spend eleven years in exile.

He later passed away at his birthplace of Luang Prabang in 1959. To Lao people, Prince Phetsarath represented both continuity with the pre-colonial past and the hope of a new, post colonial future, he was both a traditionalist, by culture and by his affinity with the Lao people among whom he was so popular, and a modernist, determined to forge a new Lao unity where a history of kingdoms and principalities had existed before.

To this day, Laotians still hang Prince Pethsarath's picture in their homes. His popularity to the Lao people is in regard to its countries pre-colonial culture and independence; he was both a traditionalist with an affinity for Lao culture and its people but also a visionary; his life and legacy is indelibly imprinted into modern history of Laos.





Guest Room

The 75 guest rooms were built while preserving the French colonial design with Laotian touch, all accommodations are furnished tastefully with wooden furniture to reminisce the heritage of the building. Breakfast as well as functions are held at Xiengkeo Restaurant, located beside the elevated banks of the Mekong River. Our restaurant provides guests with the best of international cuisine featuring Western, Thai, and Lao recipes. The combination of its high ceilings, polished marble floors, stylish colonial architecture and a panoramic view of the Mekong River gives this is one restaurant that will provide guest with a unique dining experience.



Deluxe Room

Each Deluxe room has its own balcony overlooking our immaculate gardens, the Mekong River and its surroundings. These quiet and cozy room, embodies traditional elegance with its warm woods and marble. Fully furnished with twin bedded or king bedded rooms available, individually controlled air conditioning, hair dryer, IDD telephone, full mini bar, remote control colour TV with choices of international satellite programming. A working station is available with provided stationary. The bathroom is a well-designed spacious marbled room with daily amenities, bathrobe and slippers.

ROOM OVERVIEW



AMENITIES

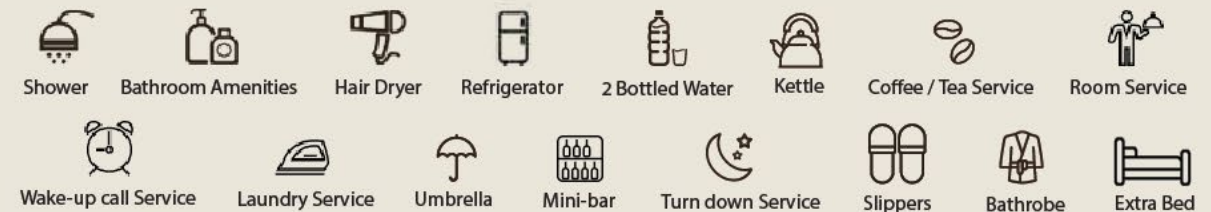



Mekong Deluxe Room

The Mekong Deluxe room are of the same size than the normal deluxe room at 35 square meters, but are located on the closest to the Mekong River and include some extra facilities for tea & coffee making and more available pillows. We have only 10 rooms of this type.

ROOM OVERVIEW



AMENITIES





Executive Suite

For guests who desire additional space and luxury, our Executive Suites are the ideal option. Nestled next to the landscaped gardens on the ground floor, overlooking the Mekong River and jungle-clad hills, these spacious suites measure 70m² and can comfortably accommodate up to three guests. Each Executive Suite comes equipped with a separate dining area and spacious terrace, making them ideal for indoor or alfresco entertaining. The bathrooms also feature separate bathtub.

ROOM OVERVIEW



AMENITIES





Mekong Executive Suite

For guests who desire additional space and luxury, our Mekong Executive Suites are the ideal option. Nestled next to the landscaped gardens on the ground floor, overlooking the Mekong River and jungle-clad hills, these spacious suites measure 96m² and can comfortably accommodate up to three guests. Each Mekong Executive Suite comes equipped with a separate dining area and spacious terrace, making them ideal for indoor or alfresco entertaining. The bathrooms also feature separate bathtub.

ROOM OVERVIEW



AMENITIES





XIENGKEO RESTAURANT

Xiengkeo restaurant provides guests with the best of international cuisine featuring Western, Thai, and Lao recipes. The combination of its high ceilings, polished marble floors, stylish colonial architecture and a panoramic view of the Mekong River gives this is one restaurant that will provide guest with a unique dining experience. The breakfast buffet is served daily in the morning on the terrace and the restaurant.

- 🍴 Thai, Laos and Western International Cuisine.
- 🪑 50 seats indoor and 80 seats out door.
- 🕒 Daily 06:30 – 22:00 hrs.









LE BISTROT

Panoramic views of the river as it flows past Luang Prabang and winds past the hotel between two mountain ranges. Le Bistrot Lounge serves light meals and boasts a full bar. The lounge and bar is fully air-conditioned and uses its fireplace during the cool winter months. Karaoke and live music are available on request.



-  Light meals.
-  Variety of Cocktails.
-  Seating from 70 attendees.
-  Daily 11:00 - 22:00 hrs.



MEETINGS AND EVENTS

All kinds of meetings and seminars can be arranged conveniently and successfully in our well-designed meeting rooms at The Grand Luang Prabang hotel. With 282 square meters at Grand Ballroom, it can be held up to 200 guests. Located perfectly next to the outdoor pool. For small or private function, up to people suits perfectly at Richeleiu Room.





RICHELIEU

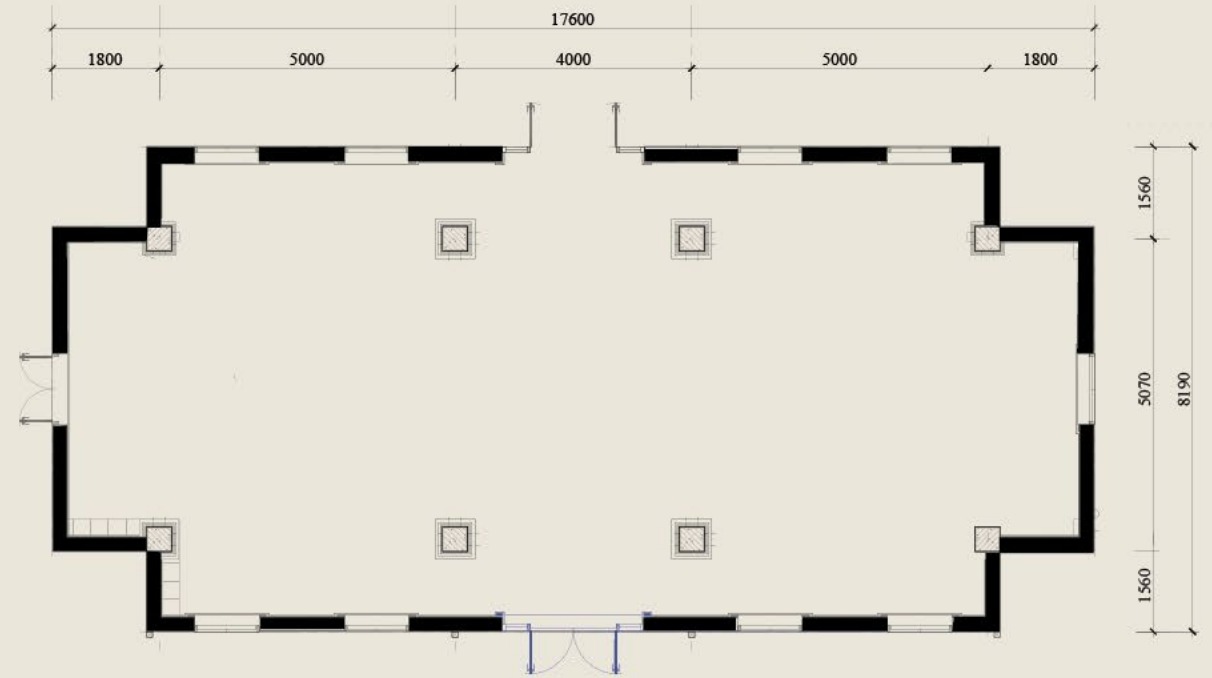

Function Room	SQM.	Capacity (Person)				
		U-Shave	Round Table	Classroom	Cocktail	Theater
Richelieu	141	50	56	60	70	90



GRAND BALLROOM

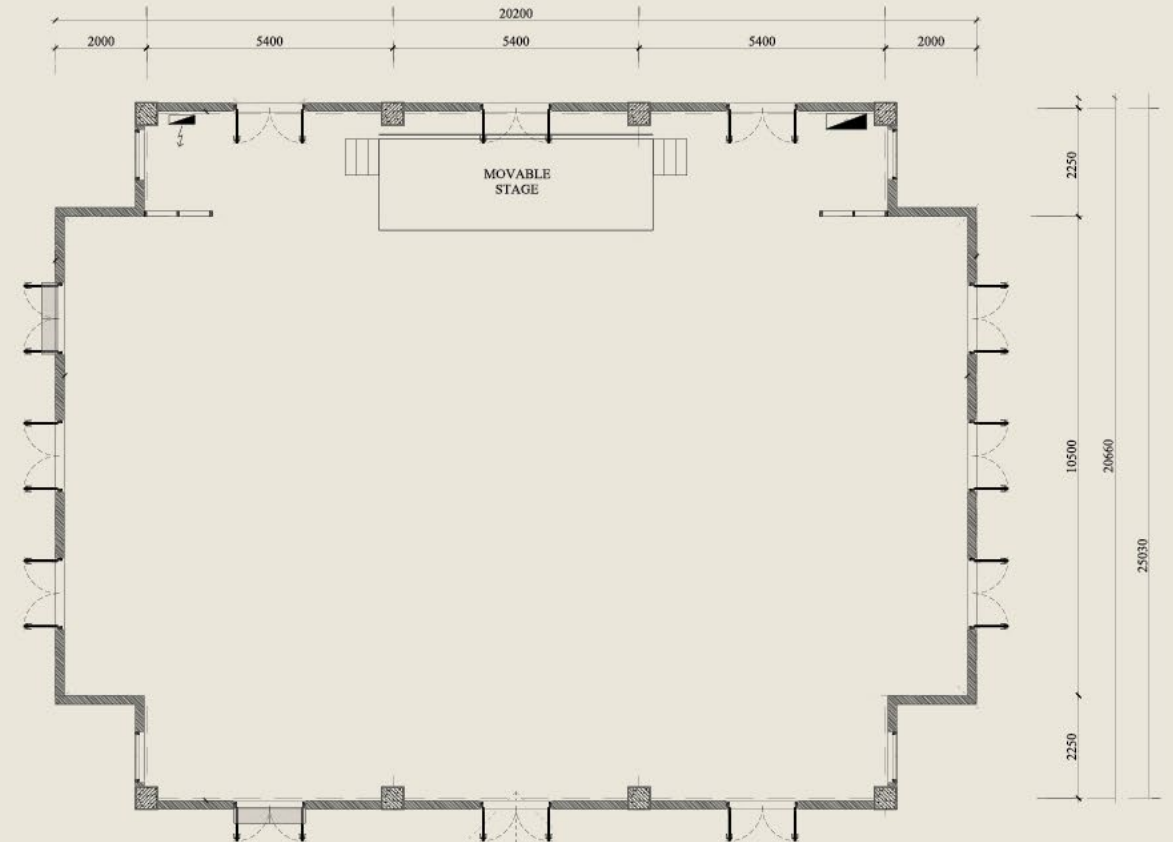

Function Room	SQM.	Capacity (Person)				
		U-Shave	Round Table	Classroom	Cocktail	Theater
Grand Ballroom	282	100	112	120	140	200



SPA

Hotel's own haven of wellness and pampering, a timeless re-imagination of the healing traditions. Choose from facial, body and massage therapies or indulge in a tailored multi-day spa package to suit your individual needs.





FACILITIES AND SERVICES

Take a dip on our large swimming pool. Relax with greenery views, glorious sunshine, your favorite sips and snacks from the Pool Bar and simply let your lay down at sun lounger.

The Fitness is a high standard facility equipped with qualified sports equipment. Hotel's health and fitness team are dedicated to providing a high quality, customer friendly service to all who use the facilities.

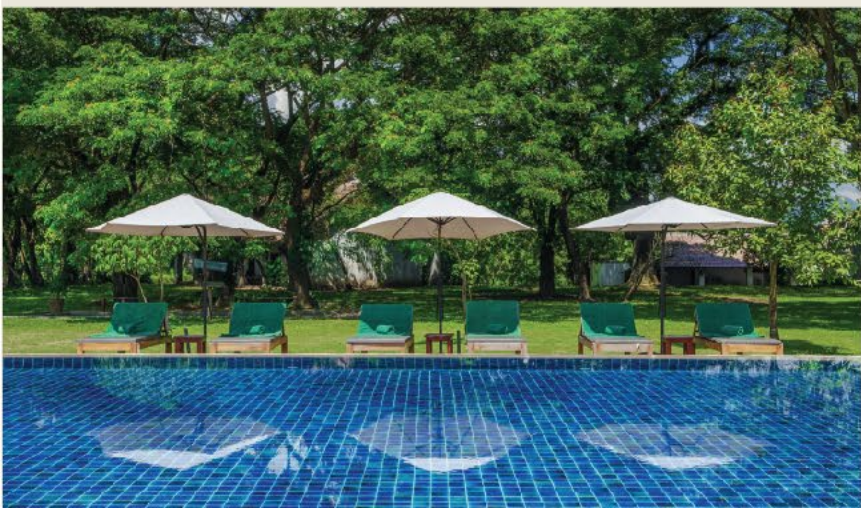



LAOS

Laos is a Southeast Asian country traversed by the Mekong River and known for mountainous terrain, French colonial architecture, hill tribe settlements and Buddhist monasteries. Vientiane, the capital, is the site of the That Luang monument, where a reliquary reportedly houses the Buddha's breastbone, plus the Patuxai war memorial and Talat Sao (Morning Market), a complex jammed with food, clothes and craft stalls.



LUANG PRABANG

Luang Prabang, the ancient capital of Luang Prabang Province in northern Laos, lies in a valley at the confluence of the Mekong and Nam Khan rivers. Inhabited for thousands of years, it was the royal capital of the country until 1975. It's known for its many Buddhist temples, including the gilded Wat Xieng Thong, dating to the 16th century, and Wat Mai, once the residence of the head of Laotian Buddhism.

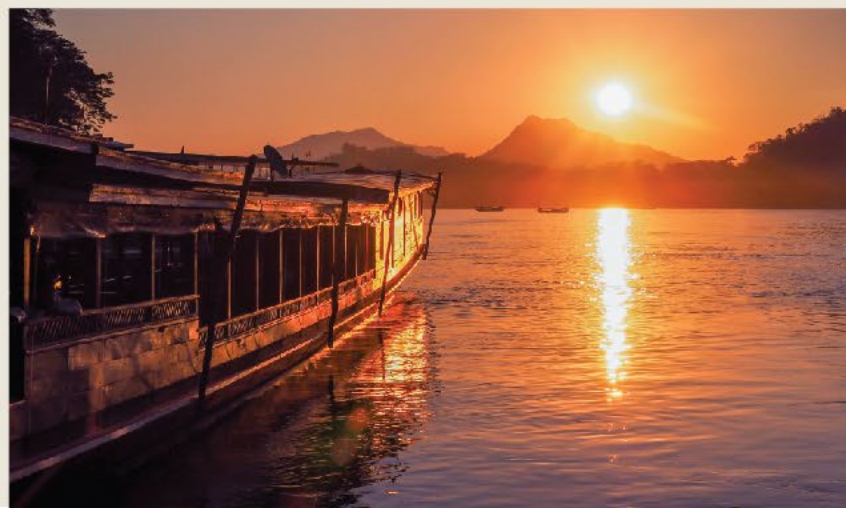



ATTRACTIONS

- Luangprabang International Airport by Car or Bus 9 km.
- Downtown by Car 4 km.
- Night Market by Car 4 km.
- Wat Xiengthong Temple by Car 4.5 km.
- Royal Palace Museum by Car 4.5 km.
- Phousi Mountain by Car 4.5 km.
- Chinese Market 1.5 km.
- Pho Si Market 1.5 km.
- Ban Chan Pottery Village by Boat 10 minutes
- Pha Tad Ke Botanical Garden by Boat 10 minutes
- The Living Land Farm by Car 2 km.
- Kuang Si Waterfall by Car or Bus 37 km.
- Tad Sae Waterfall by Car 26 km.
- Elephant Camp Village by Car 20 km.
- Ban Phanom Handicraft Village by Car 8 km.
- Pak-ou Historic Cave by Boat 2 hr. by Car 1 hr.
- Bus Terminal by Car 1.5 km.
- High Speed Train Terminal 19 km.

